



| | | | |
|--------|-----------|------------|-----------|
| | | | |
| | | | |
| Wen Li | Fang Yang | Jiang Yang | Fang Wang |

| | | | |
|--|--|--|--|
| | | | |
| | | | |
| | | | |



Tolerance: 0.25(0.01)

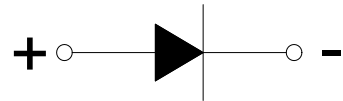
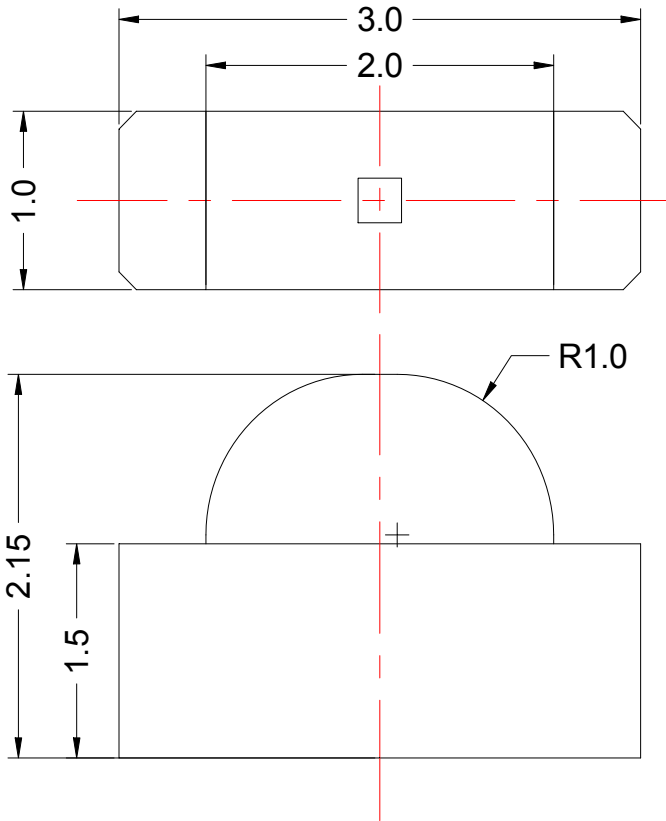

Unit mm

Color Pre Green

Length-color Water clear

Emission Material InGaN

Drawing by Oli a ion



3 Characteristic

| | | | |
|---------------------------------|-----------------|---------|----|
| | | | |
| | | | |
| Forward current | I _f | 30 | mA |
| Reverse voltage | V _r | 5 | V |
| Power dissipation | P _d | 110 | mW |
| Operating temperature range | T _{op} | -25 +80 | C |
| Storage temperature range | T _g | -30 +80 | C |
| Peak pulsed current 1/8 d f=1KH | I _{fp} | 125 | mA |

| | | | | | | |
|-----------------------------|----------------------|----------------|-----|-----|-----|-----|
| | | | | | | |
| | | | | | | |
| Wavelength at peak emission | I _f =20mA | peak | 515 | 520 | 525 | nm |
| Spectral half bandwidth | I _f =20mA | | | 10 | | |
| Forward voltage | I _f =20mA | V _f | 3.0 | | 3.8 | V |
| Minimum luminous intensity | I _f =20mA | I | 100 | 175 | 250 | mcd |
| Viewing angle at 50% IV | I _f =10mA | | -- | 120 | -- | Deg |
| Reverse current | V _r =5V | I _r | -- | -- | 5 | A |



U ef I life

-

Typical Electrical/Optical Characteristic Curve
($T_a=25^\circ\text{C}$ Unless Otherwise Noted)

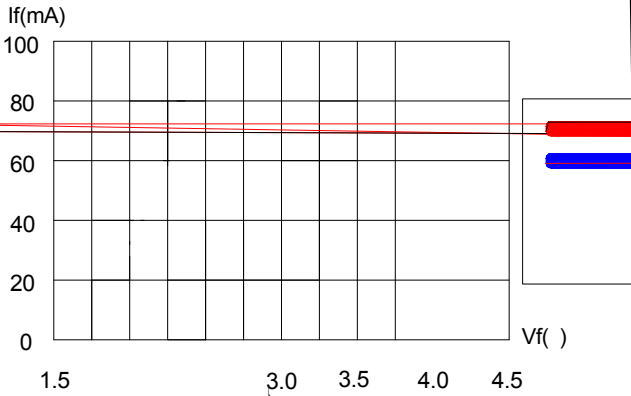

Fig.1 Forward Current vs Forward Voltage

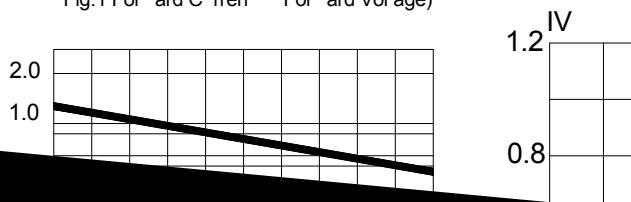

Fig.3 Relationship between In and If

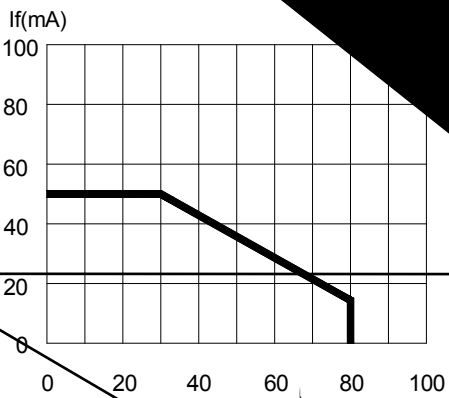

Fig.5 Maximum Forward Current vs Ambient Temperature

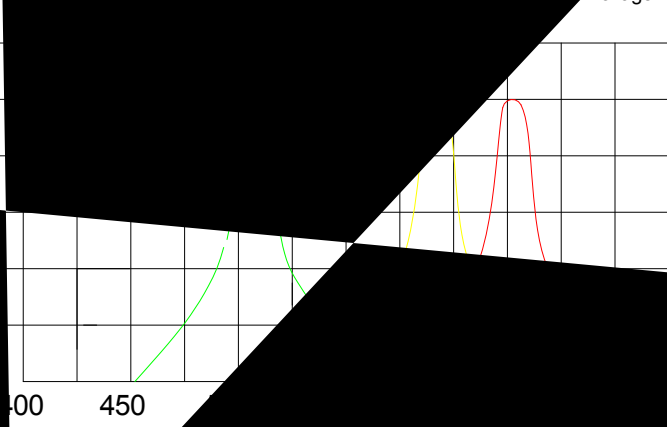

Fig.4 Forward Current vs Forward Voltage

